

PZ24-12000027

07/02/2025

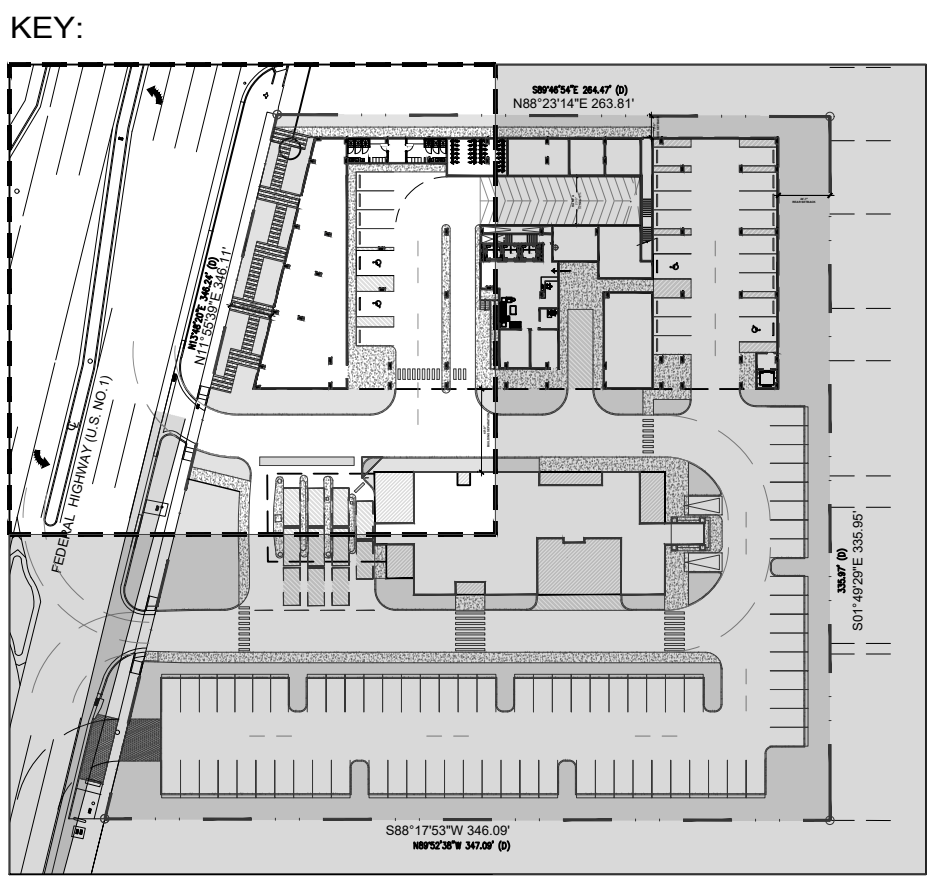

HARDSCAPE SCHEDULE					
MATERIALS					
KEY	DESCRIPTION	MANUFACTURER	COLOR	FINISH	SIZE
①	Concrete	Contractor	Grey	Standard	See civil
②	Concrete Paver	TBD	TBD	TBD	TBD

idea
Architect

absolute-idea.com

CANAL PARK
3323 NE 163rd Street, Suite 200
T 305.792.0015 F 305.931.0279 @ info@absolute-idea.com

North Miami Beach, FL 33160

SEAL

KEN GARDNER
FL LA 1569

TO THE BEST OF MY KNOWLEDGE, THE PLANS AND SPECIFICATIONS COMPLY
WITH THE APPLICABLE BUILDING CODES AND THE APPLICABLE
FIRE SAFETY STANDARDS AS DETERMINED BY THE LOCAL AUTHORITY IN
APPROVED AND ITS TECHNICAL AND CONSULTANTS.

The logos for the participating firms are displayed below the title. From top to bottom, they are: 'idea Architect' in a light blue square; '30 Years of Design' in a dark blue square with a large '30' and 'Years of Design' text; and 'FLYNN ENGINEERING' in a dark blue square with the company name in white and blue text.

[illegible]

ALL MEASUREMENTS MUST BE VERIFIED BEFORE
BEGINNING THE WORKS. NO MEASUREMENTS ARE TO
BE SCALED DIRECTLY FROM THIS DRAWING.

Key section

**PROGRESS
SET**

Client

VERA FUND
NICK POLYUSHKIN
& YURI KHARITONENKOV
TEL: 305.833.3303

Project

**1600 S FEDERAL HIGHWAY
(MIXED-USE PROJECT)**

**1600 SOUTH FEDERAL HIGHWAY,
POMPANO BEACH, FL 33062**

Hardscape Plan Groundfloor	
Drawn GS LA	Field LANDSCAPE ARCH
Verified KG	Scale as shown
Approved KG	Date 10-09-2024
Project Manager KG	Draw. no. L-101
Project 24-838	

